

Instrument Cluster Removal Guide

Cavalier

Note: Numbers on diagram correspond to number in procedure

1. Using a flat screwdriver to pry it out, remove the entire panel on the left side of the dash.
(this panel contains the fuse access door) You need to remove the entire panel, not just the door.
2. Remove the torx bolt holding the dash trim panel on.
3. Repeat steps 1 and 2 for the corresponding panel on the right side of the dash.
4. Open the glove compartment and remove 3 torx bolts along the top edge.
5. Remove 2 hex bolts at back of glove box.

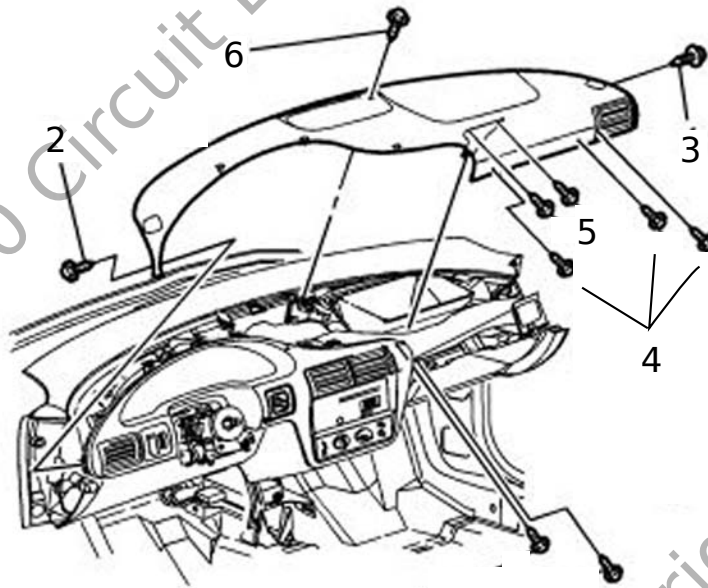

6. Remove screw holding defrost vent cover, then remove 2 torx screws under defrost cover.
7. Carefully separate top portion of dash from face of dash and remove entire top as shown above.

Note: The passenger airbag is located in the right side of the dash.

Use caution when working around airbag to prevent deployment or damaging its functionality.

Disclaimer of Liability: These instructions are provided free of charge as reference only to assist in the removal of your instrument cluster. No warranty or guarantee is provided for these instructions, and Circuit Board Medics LLC cannot vouch for completeness or accuracy. Use of the instructions is conducted at the user's risk. Circuit Board Medics LLC is not liable for and hereby excludes any and all indirect, incidental, special, or consequential damages related to the use of information contained in this instructional guide. If you have information that can be modified, added, or deleted to these instructions to help with completeness or accuracy, we welcome your feedback.

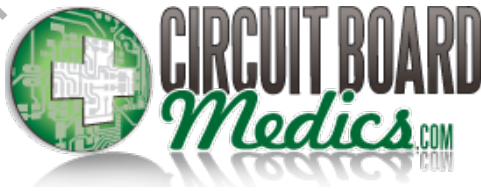

Instrument Cluster Removal Guide

Cavalier, continued

Note: Numbers on diagram correspond to number in procedure

8. Remove 3 torx screws holding face trim piece.
7. Use a flat screwdriver to pry front away from dash, disengaging clips.
8. Remove front trim piece. Note: Area over steering column is tight and may require pressing out with fingers.

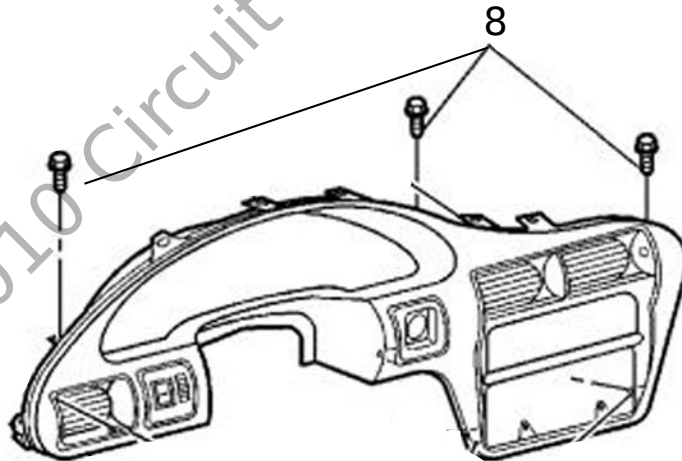

9. Remove the 2 screws from the top of the instrument cluster.
10. Remove the instrument cluster and disconnect the wiring harness.

Disclaimer of Liability: These instructions are provided free of charge as reference only to assist in the removal of your instrument cluster. No warranty or guarantee is provided for these instructions, and Circuit Board Medics LLC cannot vouch for completeness or accuracy. Use of the instructions is conducted at the user's risk. Circuit Board Medics LLC is not liable for and hereby excludes any and all indirect, incidental, special, or consequential damages related to the use of information contained in this instructional guide. If you have information that can be modified, added, or deleted to these instructions to help with completeness or accuracy, we welcome your feedback.